

## ROADMASTER S SOLAR

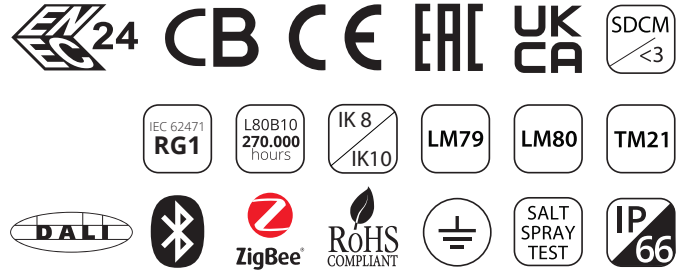

RAL 7037

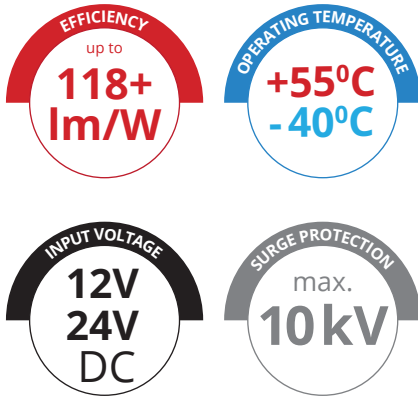

### Specifications

- IP66 class
- Aluminium injection body
- Engineered to operate in harsh and hot conditions
- Over **60.000** hours life according to LM80 and TM21 standard
- Up to **118+ lm/W** efficiency
- 12VDC / 24VDC input voltage
- 10kV surge protection
- -40°C / +55°C operating temperature
- Aluminum PCB (2,0 W/mK)
- SMD PCB connector
- Special silicone gasket
- Brass cable gland and brass ventilation valve
- Photometric solutions for different road applications
- Measurements according to EN 60598-1 standards
- Photometric measurements according to IESNA-LM-79-08

### Application Areas

- ME3 - ME4 - ME5 Class Street Lighting
- Park & Garden

### Optional

- Marine protective coating
- 4 pins ZHAGA socket options
- Toolless access to the driver compartment
- Power cut if the power unit cover is opened
- Sensor, dimming, wireless communication features
- I-10V, DALI automation integration

### Beam Angles

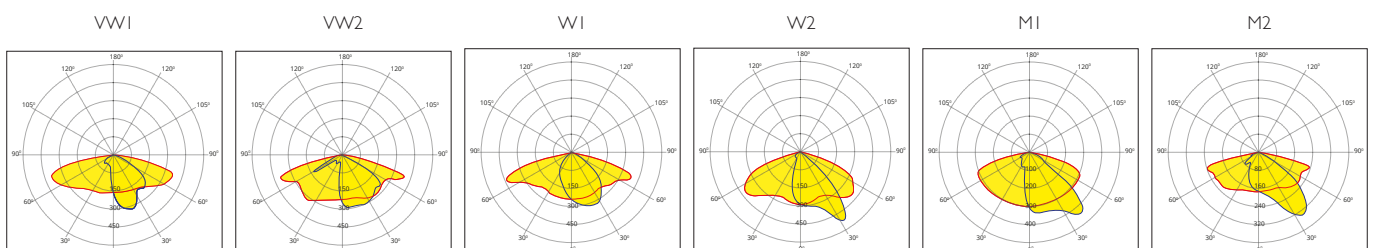

**Dimensions**

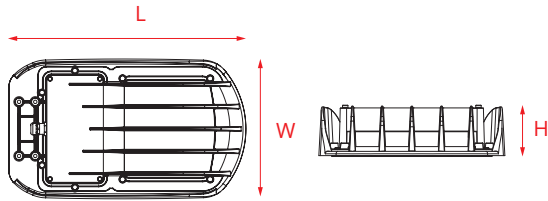

Mounting Bracket (Standard)

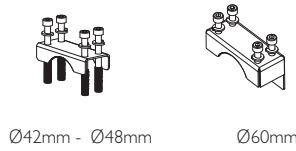

Tiltable mounting bracket is optional. According to the pole diameter, an additional bracket suitable for 48/60 mm diameter should be ordered.

**Mounting Options**

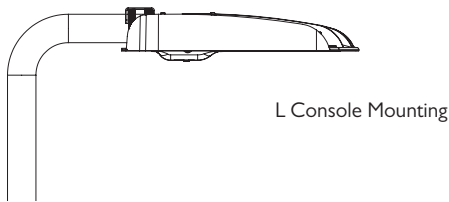

Tiltable mounting bracket (Opsiyonel / Optional)

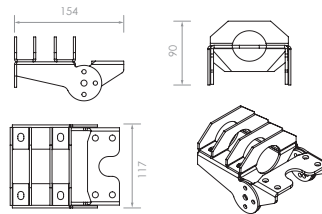

Tiltable mounting bracket is only for pole mounting

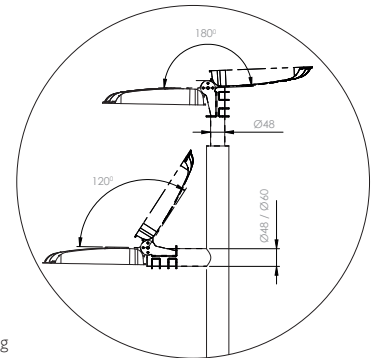

**Product Photos**

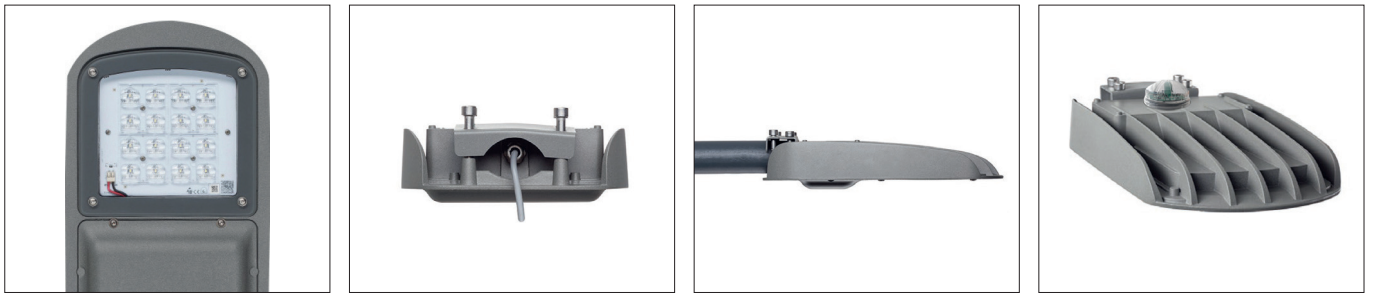

**Roadmaster S Solar**

	W	lm	lm/W	LED	▲	K	⚡	CRI	IP	L (mm)	W (mm)	H (mm)	📦 gr	
12V	S512 H33W	33	3652	111	NICHIA / SAMSUNG LUMILEDS	M1	4000	12V DC	>70	IP66	350	206	57	3100
	S712 H45W	45	4717	105	NICHIA / SAMSUNG LUMILEDS	M1	4000	12V DC	>70	IP66	350	206	57	3100
	S812 H57W	57	5380	94	NICHIA / SAMSUNG LUMILEDS	M1	4000	12V DC	>70	IP66	350	206	57	3100
24V	S524 H33W	31	3652	118	NICHIA / SAMSUNG LUMILEDS	M1	4000	24V DC	>70	IP66	350	206	57	3100
	S724 H45W	42	4717	112	NICHIA / SAMSUNG LUMILEDS	M1	4000	24V DC	>70	IP66	350	206	57	3100
	S824 H57W	51	5380	105	NICHIA / SAMSUNG LUMILEDS	M1	4000	24V DC	>70	IP66	350	206	57	3100

Power and lumen values are within ± 5% tolerance.

Lumen Multiplier Table

CRI	3000K	4000K	5000K	6500K
70	0,95	1,00	1,00	0,97
80	0,88	0,95	0,95	0,93
90	0,75	0,80	0,80	0,80