

SAVER COMPACT HBM PLUS

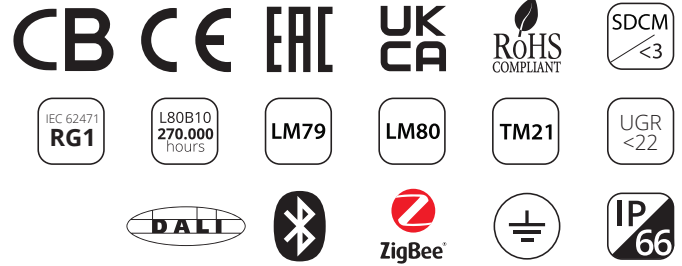

RAL 9005

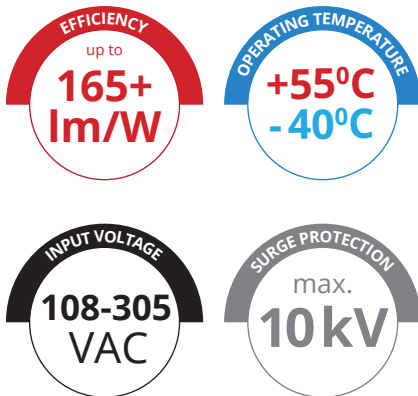

Specifications

- IP66 protection
- Engineered to operate in harsh and hot conditions
- Over **60.000** hours life according to LM80 and TM21 standard
- Up to **165+ lm/W** efficiency
- **108-305VAC** input voltage range against voltage fluctuation
- **10kV** surge protection
- Special design 6063 aluminium extrusion cooling system
- **-40°C / +55°C** operating temperature
- Aluminum PCB (2,0 W/mK)
- SMD PCB connector
- Special silicone gasket
- Brass cable gland and brass ventilation valve
- Multiple mounting options
- Measurements according to EN 60598-1 standards
- Photometric measurements according to IESNA-LM-79-08

Application Areas

- Industrial Plant Lighting
- Warehouse Lighting
- Area Lighting
- Sports Center Lighting

Optional

- Sensor, dimming, wireless connection features
- I-10V, DALI automation integration
- Emergency mode

Beam Angles

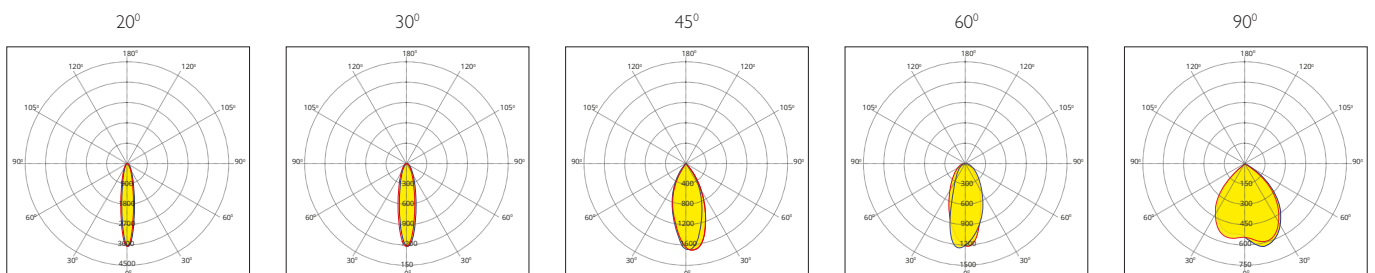

Dimensions

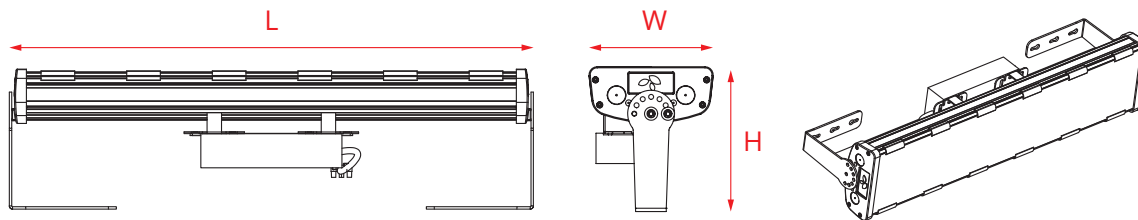

Mounting Options

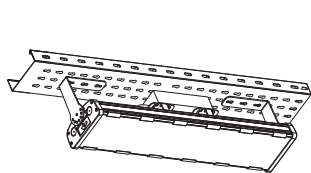

Cable Tray Mounted

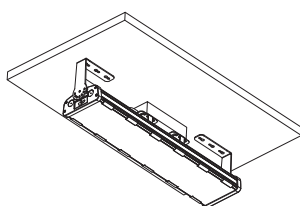

Ceiling Mounted

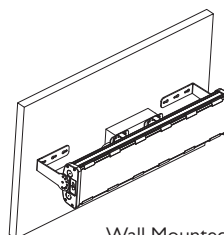

Wall Mounted

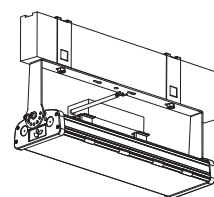

Busbar Mounted

Product Photos



Saver Compact HBM Plus

W	lm	lm/W	lm	lm/W	lm	lm/W	LED	K	AC	CRI	IP	L (mm)	W (mm)	H (mm)	gr.
	▲20°		▲30°		▲45°/60°/90°										

	W	lm	lm/W	lm	lm/W	lm	lm/W	LED	K	AC	CRI	IP	L (mm)	W (mm)	H (mm)	gr.	
L SERIES	HBM PLUS L70	70	11555	165	10729	153	11463	164	LUMILEDS / NICHIA SEOUL	4000	108-305VAC	>70	IP66	476	150	176	4860
	HBM PLUS L90	90	14617	162	13572	151	14500	161	LUMILEDS / NICHIA SEOUL	4000	108-305VAC	>70	IP66	476	150	176	4860
	HBM PLUS L117	117	18740	160	17400	149	18590	159	LUMILEDS / NICHIA SEOUL	4000	108-305VAC	>70	IP66	476	150	176	4860
	HBM PLUS L139	139	22249	160	20658	149	22071	159	LUMILEDS / NICHIA SEOUL	4000	108-305VAC	>70	IP66	662	150	176	6291
	HBM PLUS L175	175	27530	157	25562	146	27310	156	LUMILEDS / NICHIA SEOUL	4000	108-305VAC	>70	IP66	662	150	176	6291
	HBM PLUS L192	192	30178	157	28020	146	29936	157	LUMILEDS / NICHIA SEOUL	4000	108-305VAC	>70	IP66	662	150	176	6291
M	HBM PLUS M242	242	36991	153	34347	142	36695	152	LUMILEDS / NICHIA SEOUL	4000	108-305VAC	>70	IP66	662	150	176	6291
H SERIES	HBM PLUS H96	96	14450	151	13417	140	14335	149	LUMILEDS / NICHIA SEOUL	4000	108-305VAC	>70	IP66	476	150	176	4860
	HBM PLUS H106	106	-	-	-	-	14324	135	LUMILEDS / NICHIA SEOUL	4000	108-305VAC	>70	IP66	662	150	176	6291
	HBM PLUS H148	148	22232	150	20643	139	22054	149	LUMILEDS / NICHIA SEOUL	4000	108-305VAC	>70	IP66	662	150	176	6291

Lumen Multiplier Table

CRI	3000K	4000K	5000K	6500K
70	0,95	1,00	1,00	0,97
80	0,88	0,95	0,95	0,93
90	0,75	0,80	0,80	0,80

Power and lumen values are within ± 5% tolerance.